

Altea Slate Shower Tray Installation Manual

**THIS PRODUCT MUST BE INSTALLED
BY A QUALIFIED PLUMBER**



IMPORTANT - STORE TRAY ON FLAT

PRIOR TO INSTALLATION

Before installation, the shower tray must be thoroughly inspected for any defects. In the unlikely event that a defect is found, do not install the product. Instead, return it to the supplier, who will arrange a replacement if necessary.

Checks should include, but not limited to, the following:

- ✓ Ensure that the colour and finish of the shower tray is acceptable
- ✓ Ensure that the product is not cracked or chipped.
- ✓ Ensure that there is no twisting or distortions of the product.
- ✓ Ensure that the shower tray suitably drains water when levelled.
- ✓ Ensure that the shower tray is the correct size by checking lengths with a measuring tape.
- ✓ Waste Installation: A minimum of 300mm of straight pipe is required before any bends.

The manufacturer will not be held liable for the cost of removal, replacement, or any other expenses incurred due to a defective shower tray if the defect was identifiable prior to installation.

It is the responsibility of the installer or end user to inspect the product thoroughly before fitting.

INSTALLATION OF THE SHOWER TRAY WILL BE TREATED AS ACCEPTANCE OF QUALITY.

CHECKING FOR TWISTS

Place the shower tray on a flat level surface.

Using a spirit level, ensure that all outer edges of the shower tray are flat and level as per figure 1.

If any of the levels cannot be corrected when embedding the shower tray, then it may be twisted or distorted. If this is the case, then the shower tray must not be installed and should be returned to the retailer for replacement.

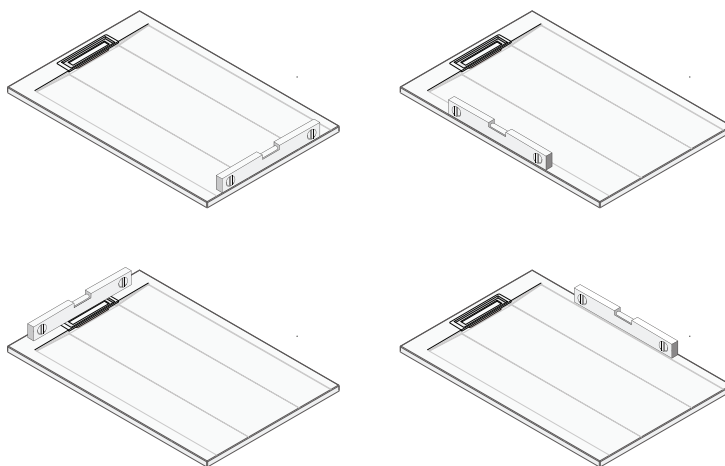

Figure 1

AFTER SALES & TECHNICAL SUPPORT

Our highly experienced after sales and technical support team are always on hand to help should you require technical advice or a spare part.

T: +44 (0)28 3025 9988

E: technical@mylifebathrooms.com

Altea Slate Shower Tray Installation Manual

**THIS PRODUCT MUST BE INSTALLED
BY A QUALIFIED PLUMBER**



CUTTING INSTRUCTIONS

Rectangle Trays Only - All rectangle trays have a 75mm flat end for cutting.

Preparation:

Wear safety gear: goggles, gloves, and a dust mask.
Mark the cutting line clearly using a pencil and straight edge or masking tape.

Tool Selection:

Use a diamond-tipped circular saw blade or an angle grinder with a diamond blade. Ensure the blade is suitable for cutting fibreglass-reinforced plastics.

Cutting Process:

Secure the tray on a stable surface to prevent movement.
Cut slowly and steadily along the marked line. Avoid stopping mid-cut to prevent chipping. Cut from the underside to reduce visible chipping on the finished surface.

Finishing:

Smooth the cut edges with fine-grit sandpaper or a file.
Clean the tray thoroughly to remove dust and debris.

Installation Tip:

Position the cut edge against a wall to hide any imperfections.

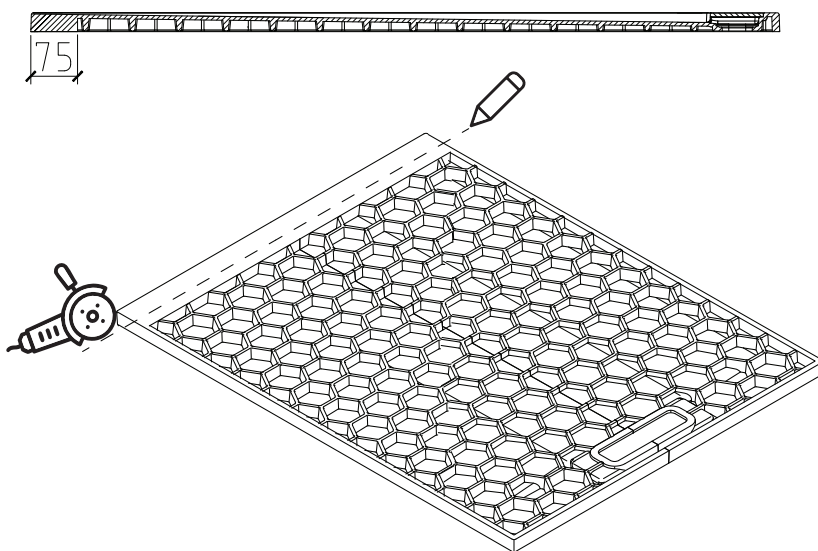

INSTALLATION INSTRUCTIONS



Note that this shower tray is suitable for installation on both wooden and concrete floors. If fitting to a wooden floor, it is recommended that the base be made from marine ply as it resists delamination under humid conditions.

Waste Installation: A minimum of 300mm of straight pipe is required before any bends.

Use the box to protect the tray during the tiling and completion process.

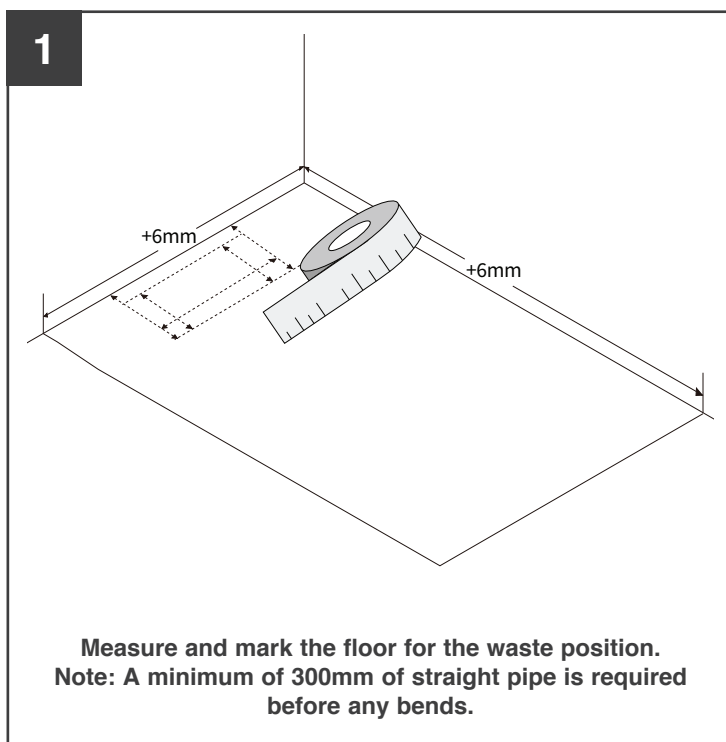

Altea Slate Shower Tray Installation Manual

**THIS PRODUCT MUST BE INSTALLED
BY A QUALIFIED PLUMBER**



INSTALLATION

2

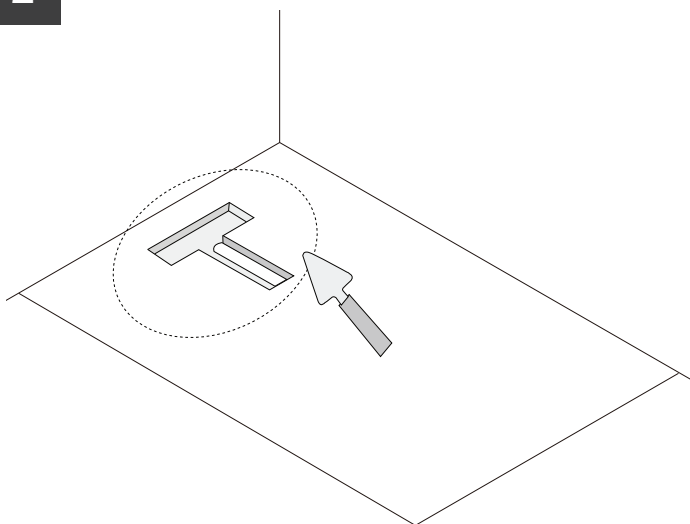

Form a trench in the floor to hold the waste unit and piping. Install the waste unit and piping in accordance with building regulations.

3

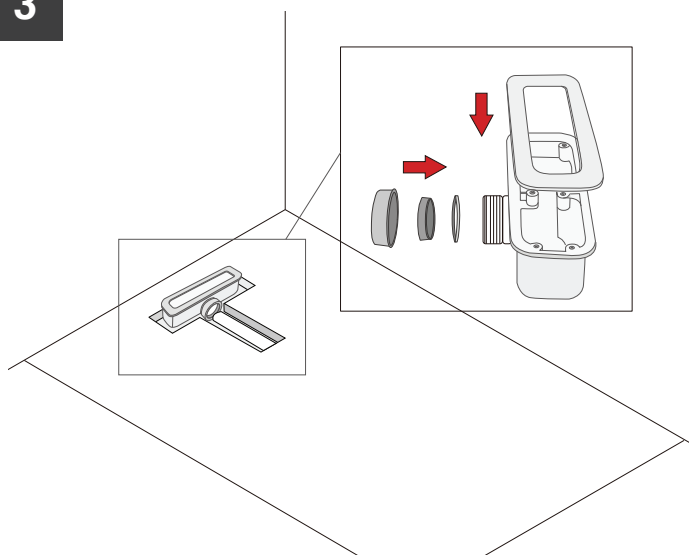

Install the waste unit and piping in accordance with building regulations. Ensure the waste pipe has a sufficient fall to allow water to drain properly.

4

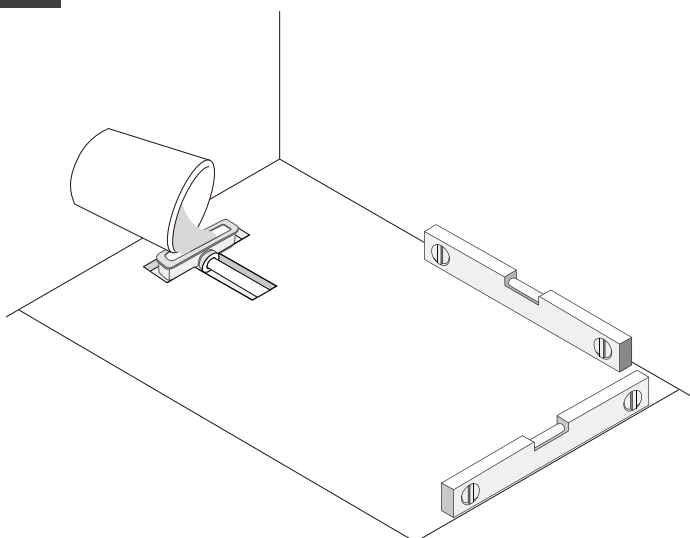

Flow test the waste an piping set up to ensure adequate drainage.

5

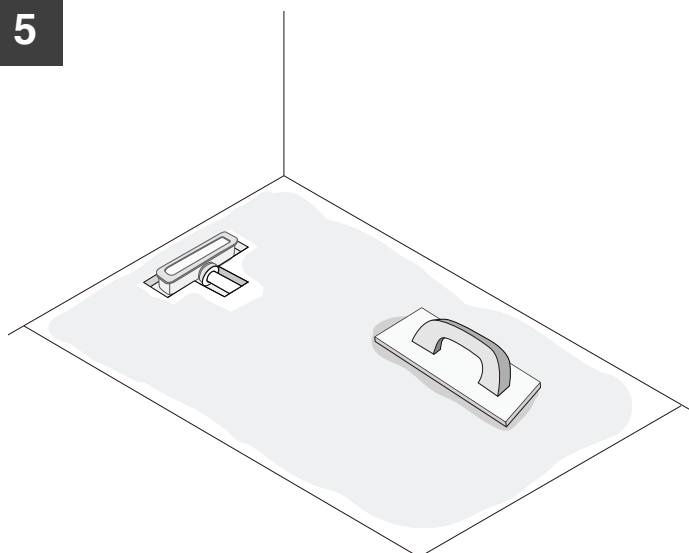

Ensure the floor is clean, dry, and level. (A tiling primer may be needed with a plywood base to enhance bonding). Apply a flexible tile adhesive to the prepared floor surface and spread it evenly using a notched trowel.

Altea Slate Shower Tray Installation Manual

THIS PRODUCT MUST BE INSTALLED
BY A QUALIFIED PLUMBER



INSTALLATION

6

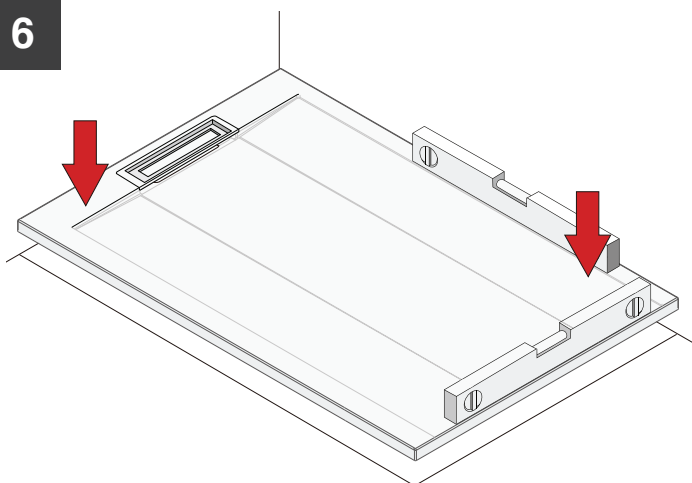

Carefully lower the shower tray onto the adhesive bed, ensuring it's in the correct position and sits flat. Use a spirit level to check that it's level in all directions. Lift one edge slightly to see if the adhesive is making full contact with the whole underside. If there are any gaps, add more adhesive where needed. Then place the tray back down and check again that it's level. Press down gently to make sure it sticks firmly.

7

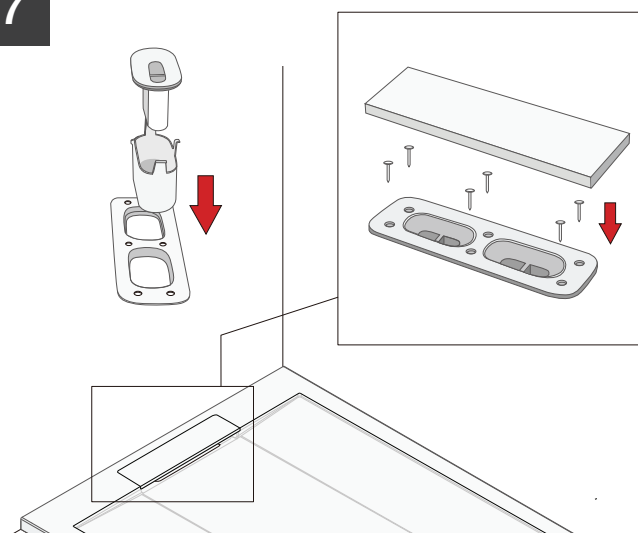

Fit the siphon cups and hair filters into the waste outlet, making sure they are seated properly. Once in place, secure the screws firmly. After everything is secured, fit the cover grid on top to complete the assembly.

8

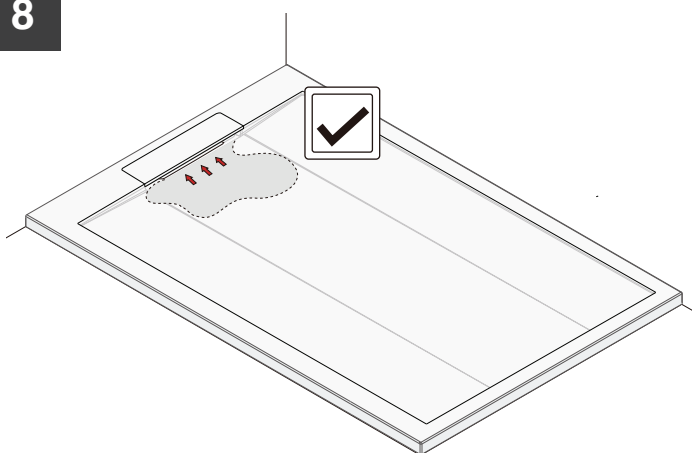

Before proceeding further, ensure the shower tray drains properly by pouring a generous amount of water over all areas. If water fails to drain effectively, first verify that the tray is level using a spirit level. If the tray is level but drainage remains poor, inspect the waste pipe for any blockages. Under no circumstances should tiles, wall panels, shower doors, screens, or any other related fixtures be installed until the shower tray has been confirmed to function correctly.

9

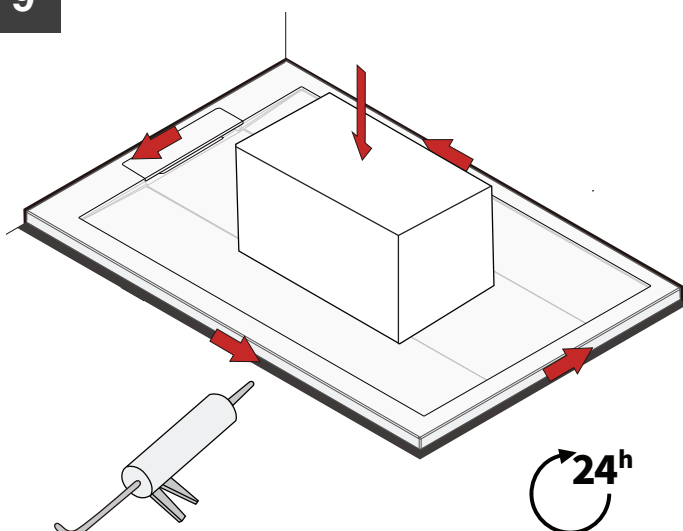

After confirming that the tray has adequate drainage, seal all the edges using a high-quality, mold-resistant silicone sealant to ensure a watertight seal. Allow the sealant to cure for at least 24 hours before using the shower tray.

Altea Slate Shower Tray Installation Manual

**THIS PRODUCT MUST BE INSTALLED
BY A QUALIFIED PLUMBER**



CARE INSTRUCTION

It is normal for small amounts of localized water to be retained on the shower tray surfaces after use which should be wiped dry immediately to prevent build up of sediments.

- Clean regularly with a PH Neutral Detergent, rinse well with water until there is no residue from detergent & dry.
- To remove any residue simply wipe with a clean cloth and PH Neutral Detergent, rinse well with water.
- Avoid the use of scouring sponges as well as alcohol, acid or abrasive cleaners.