

# 300 MOVING FLIPPER

## INSTALLATION INSTRUCTIONS

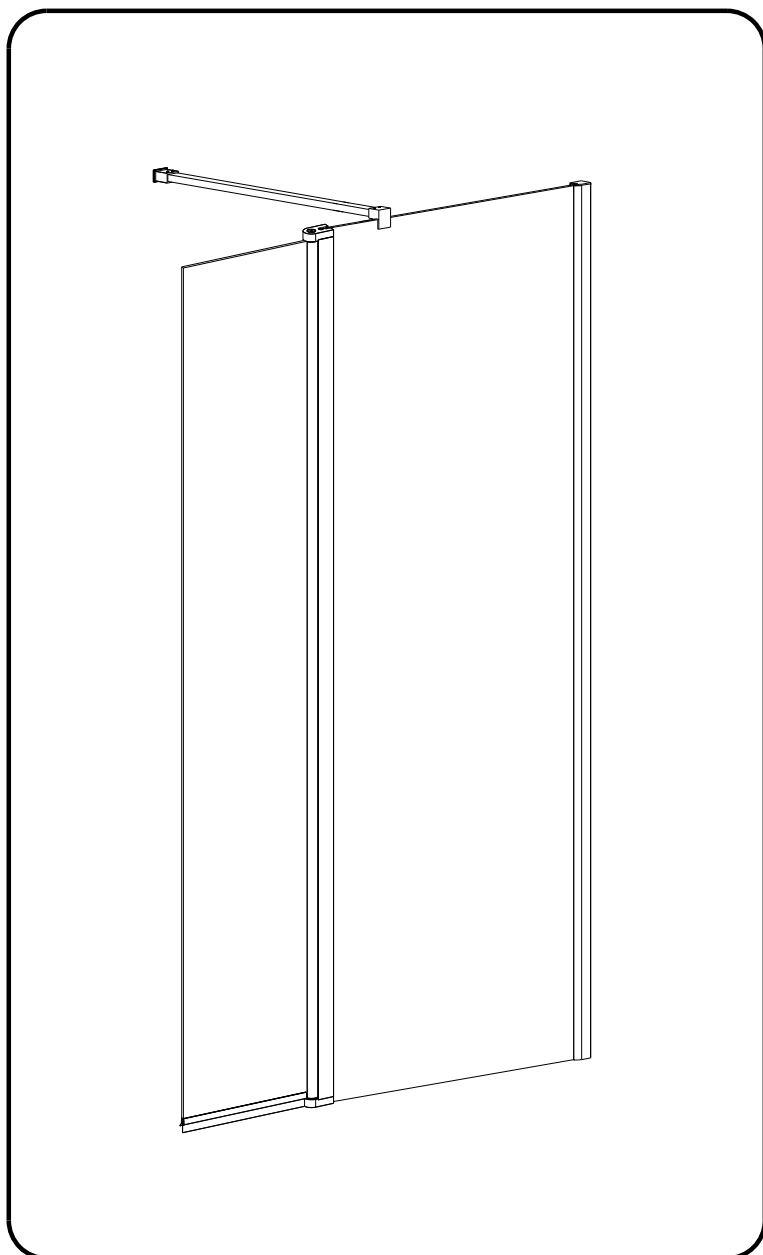

### Tools Required



**Drill**

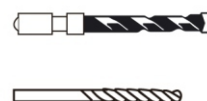

6mm Masonry Drill  
3.2mm HSS Drill

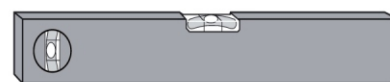

**Spirit level**

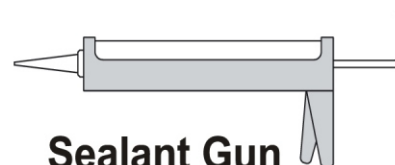

**Sealant Gun**

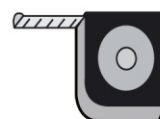

**Tape Measure**



**Pencil**



**PH2 TYPE  
Screwdriver**

Please not hand tools **NOT** supplied.

## IMPORTANT

These instructions assume that installation is done against solid/tiled walls.

The wall plugs supplied with the installation kit are for use on solid walls. Hollow or stud-partition walls will require alternative fixings. Please consult with a reputable trades person or hardware supplier for the correct type of fixing.

It may also be necessary to consult your tiling supplier about the correct method drilling your tiles.

## Components And Box Contents

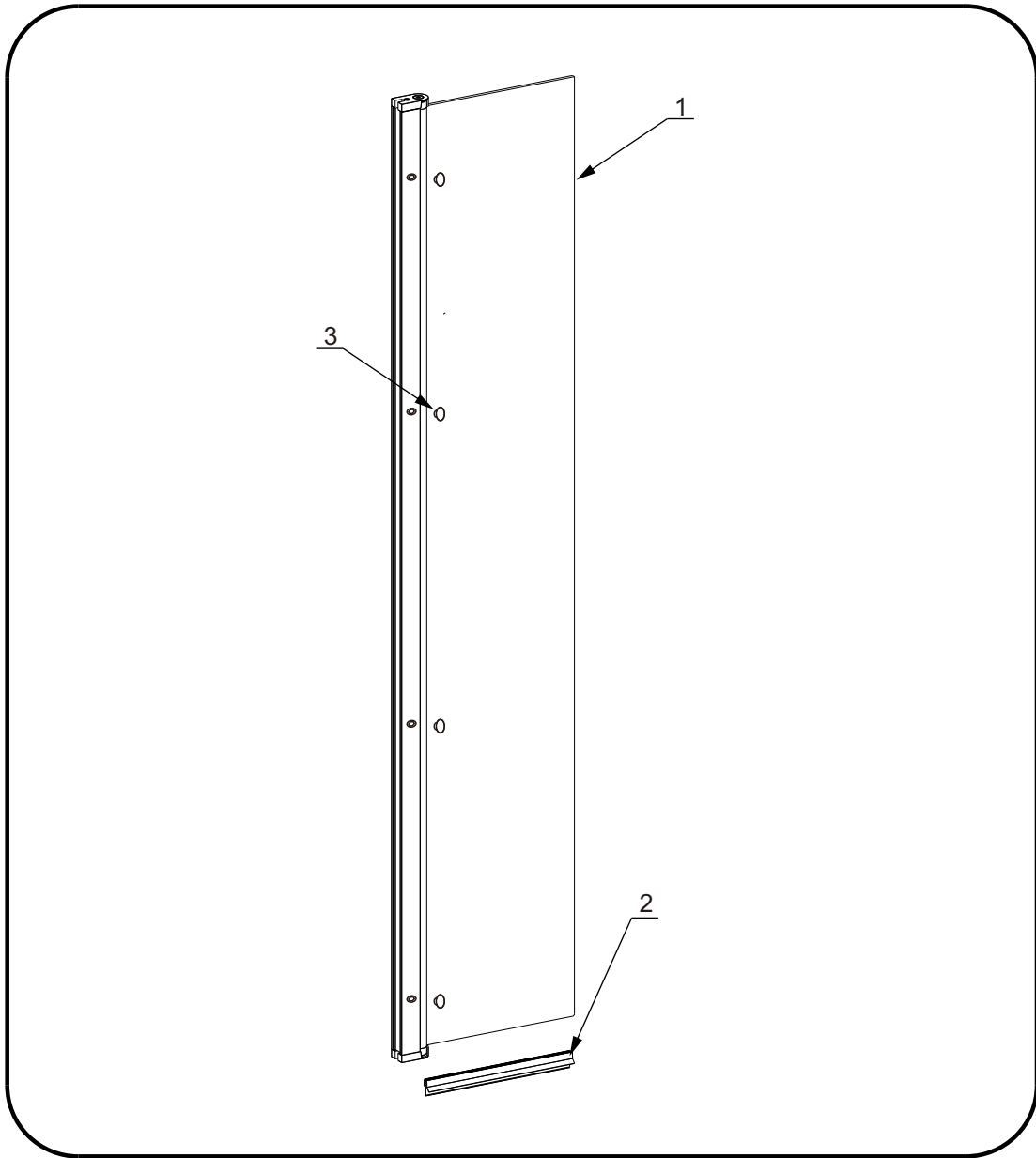

NO.	Code	Description	Qty
1	MLWPFL30-01	300 Moving Flipperi	1
2	MLWPFL30-02	Seal	1
3	MLWPFL30-03	Screw Cover Caps	4

# Installation Steps

## Step1

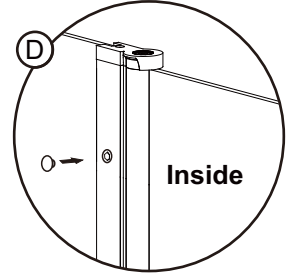
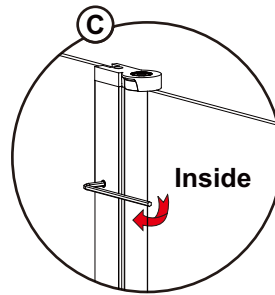
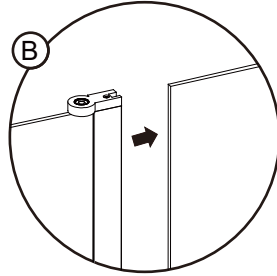
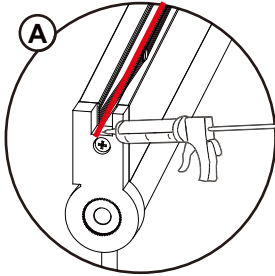
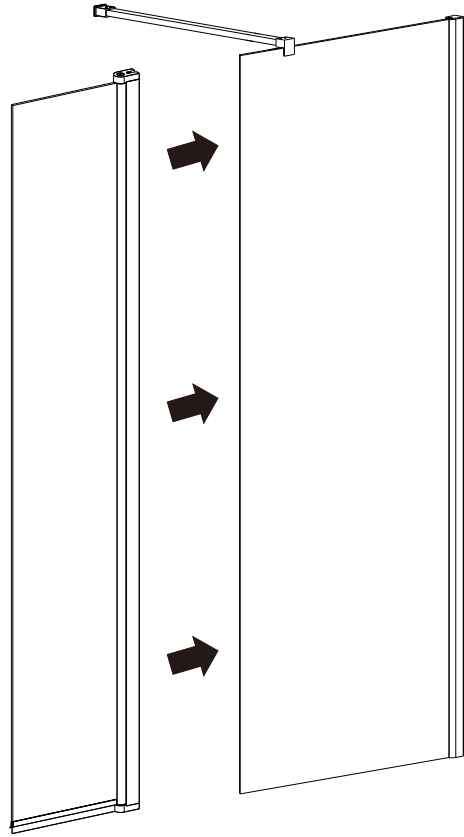
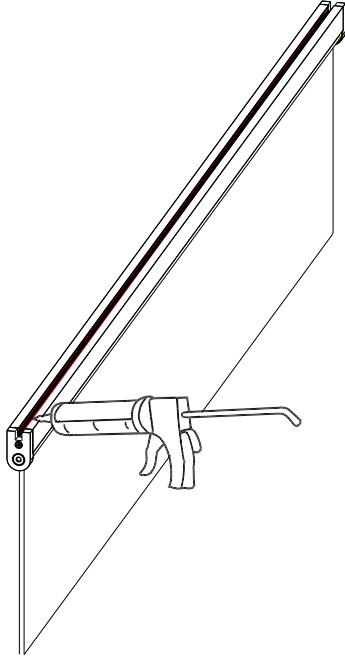

## Step2

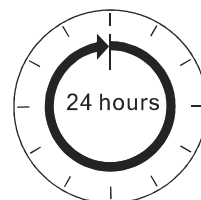
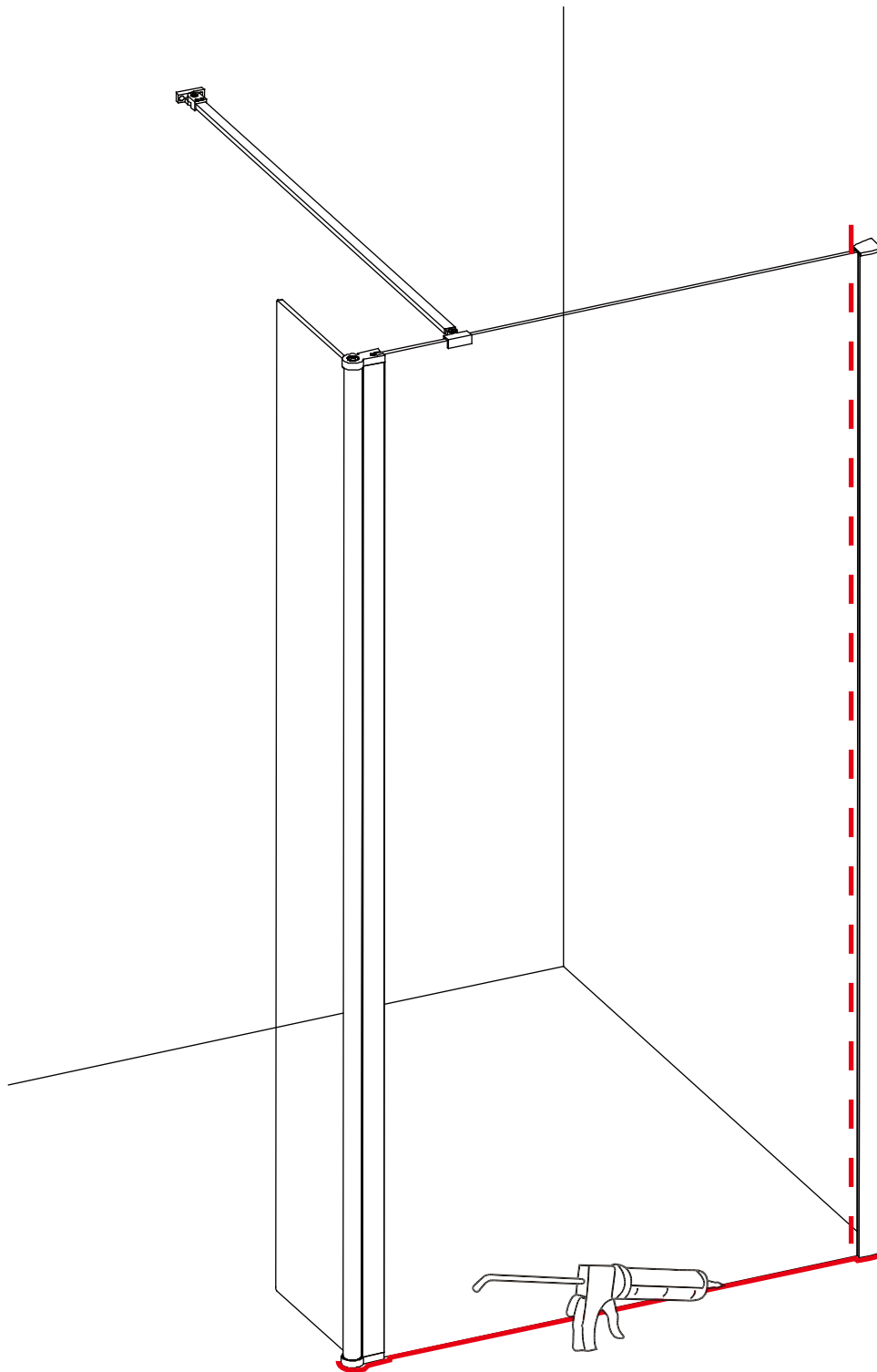

**Allow 24 hours for silicone to dry before use.**

**Silicone on the outside edge only**