

Fitted Furniture Installation Manual

FITTED FURNITURE MUST BE INSTALLED
BY A QUALIFIED INSTALLER.



PRE-INSTALLATION INFORMATION

- Please read installation instructions fully before commencing installation.
- Check that the units are compatible with your current requirements.
- Before installation, please make sure you have received all items and that they are undamaged. Any damage claims after installation will not be accepted.
- Please check for any hidden pipes and cables, electric or otherwise before drilling holes in a wall.
- This furniture is designed for use within domestic environments only, adequate ventilation should be in place and a good quality bathroom extractor fan is strongly recommended in order to help prevent condensation which can cause damage to the furniture units.
- Bathroom furniture should not be installed in areas where it will come in regular contact with water. Any spillages or splashes should be wiped dry straight away and not be allowed to lie on any surface. Failure to do so can cause damage to the unit.
- All cut edges must be sealed with a suitable good quality varnish or silicone sealant, especially around basins, cut panels / plinths, trimmed worktops and bath panels. Failure to correctly seal cut edges will invalidate the warranty. A silicone sealant must be used around basins, worktops and bath panels.
- Wall plugs supplied are only suitable for solid stone / brick walls. For plasterboard or other wall types use suitable wall plugs / fittings.
- All doors will be supplied un-drilled for handles to allow you the choice of handle and position. Your qualified installer will be able to fit them to suit.
- Each individual unit must be fixed to the wall using the adjustable hanging brackets and suitable wall fixings, this is still the case where units are fitted together.

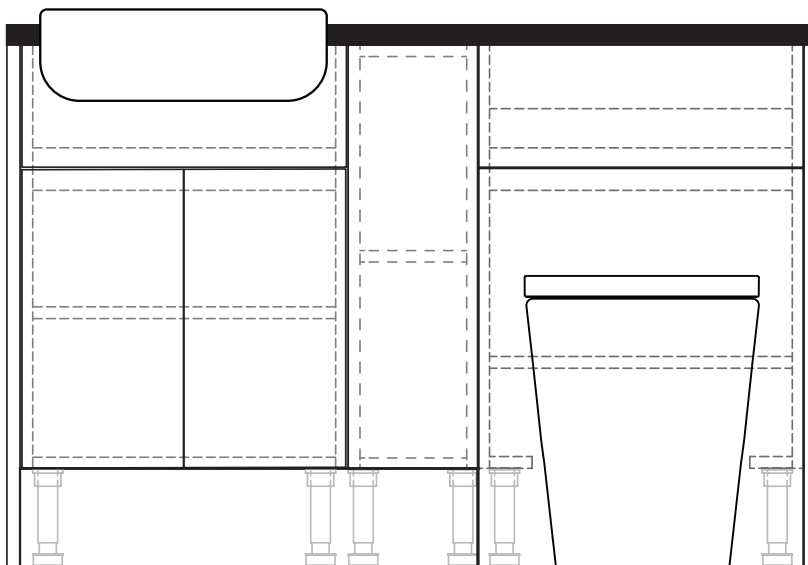

AFTER SALES & TECHNICAL SUPPORT

Our highly experienced after sales and technical support team are always on hand to help should you require technical advice or a spare part.

T: +44 (0)28 3025 9988

E: technical@mylifebathrooms.com

WC Back To Wall Unit Installation Manual

Contents

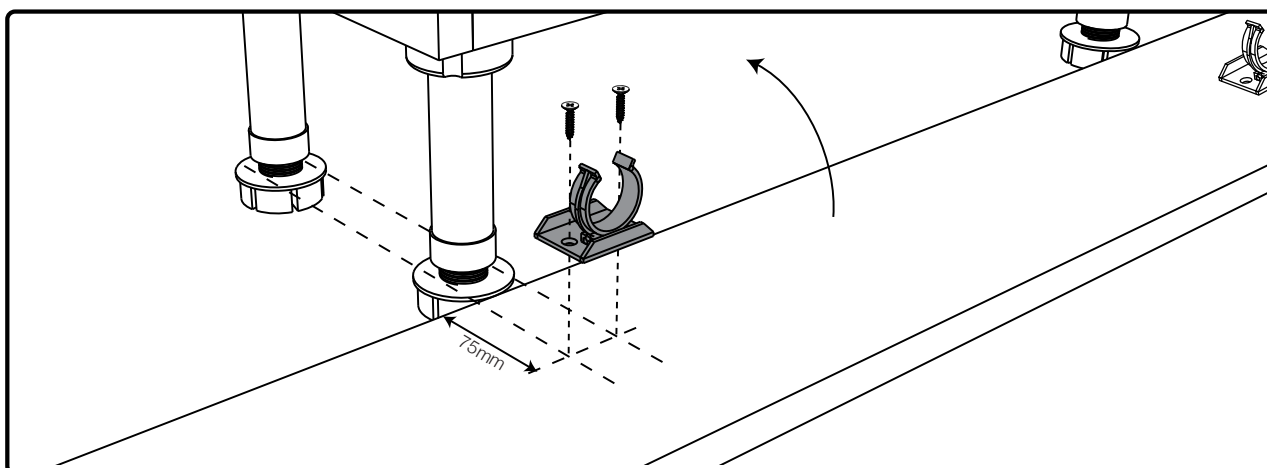
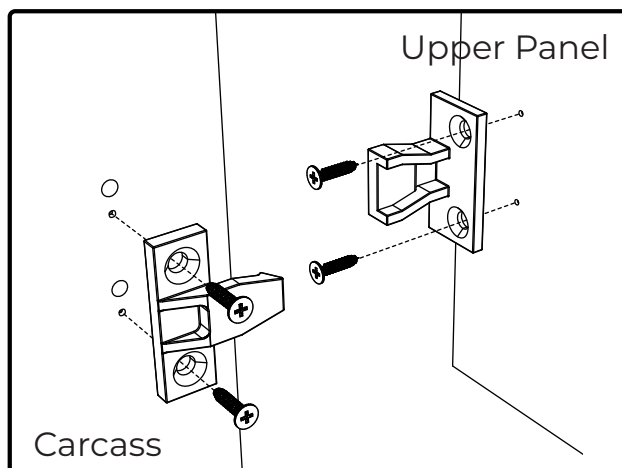
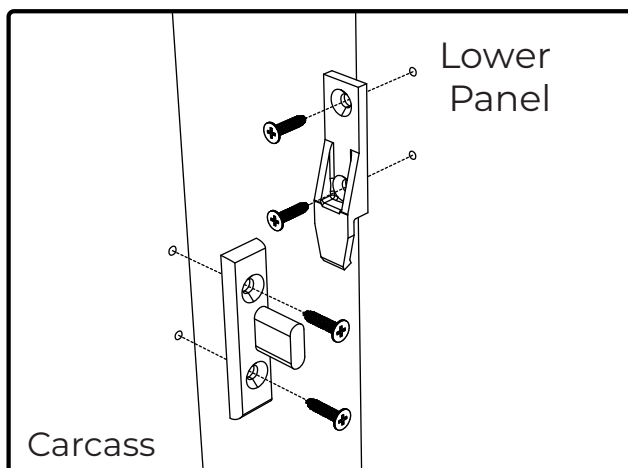
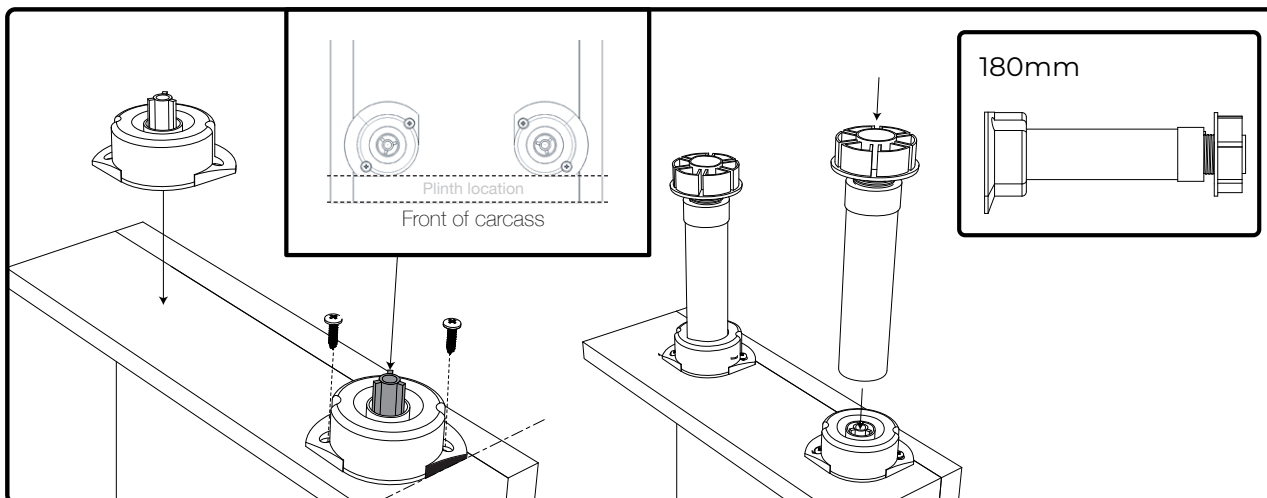
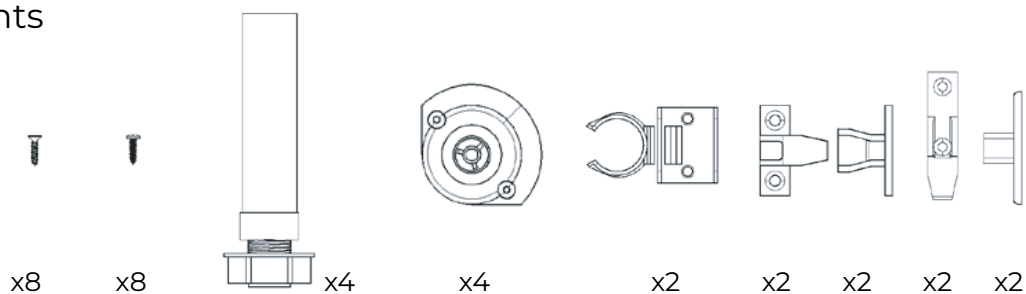

Basin Unit Installation Manual

Contents

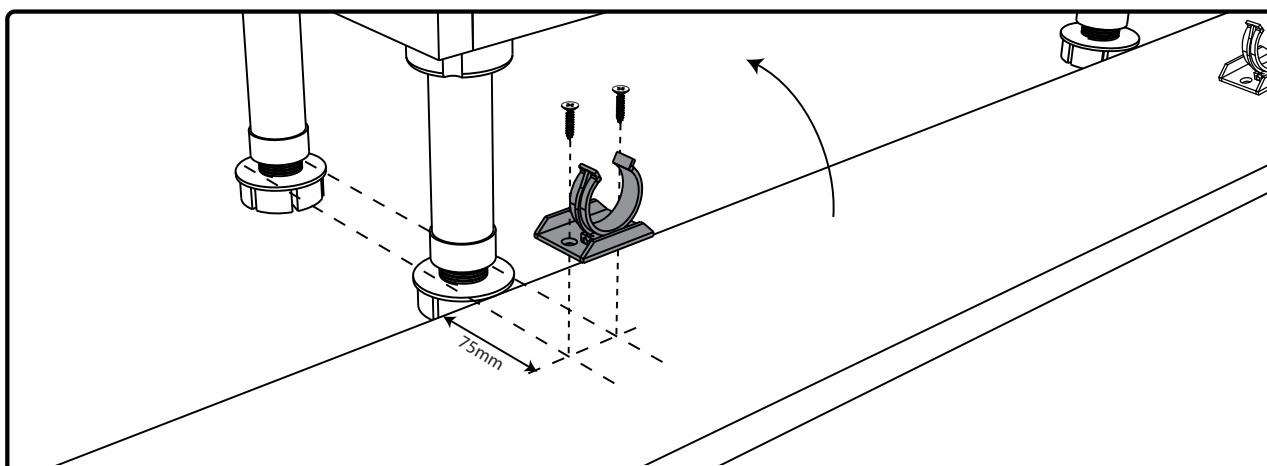
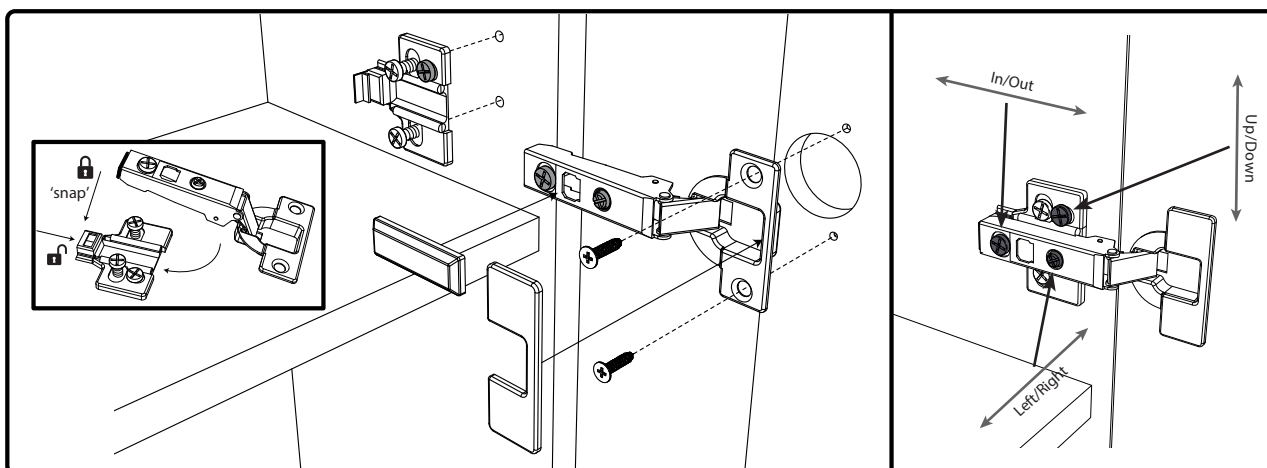
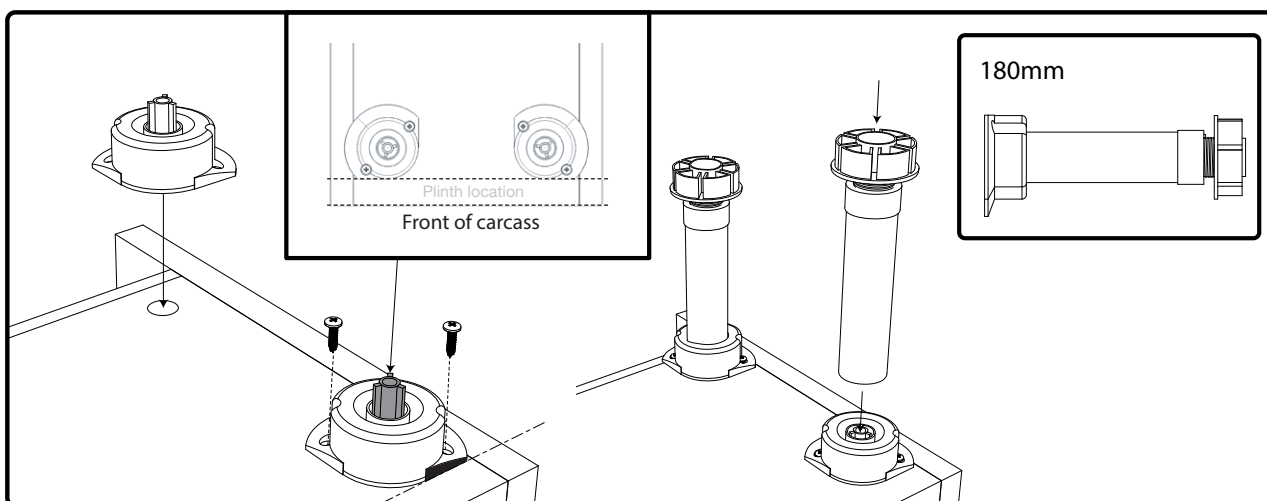
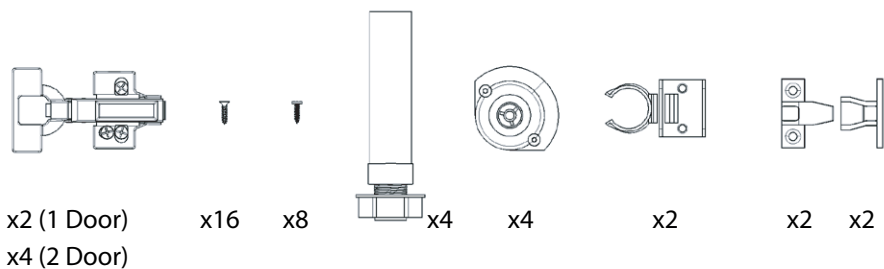

Base Unit Installation Manual

Contents

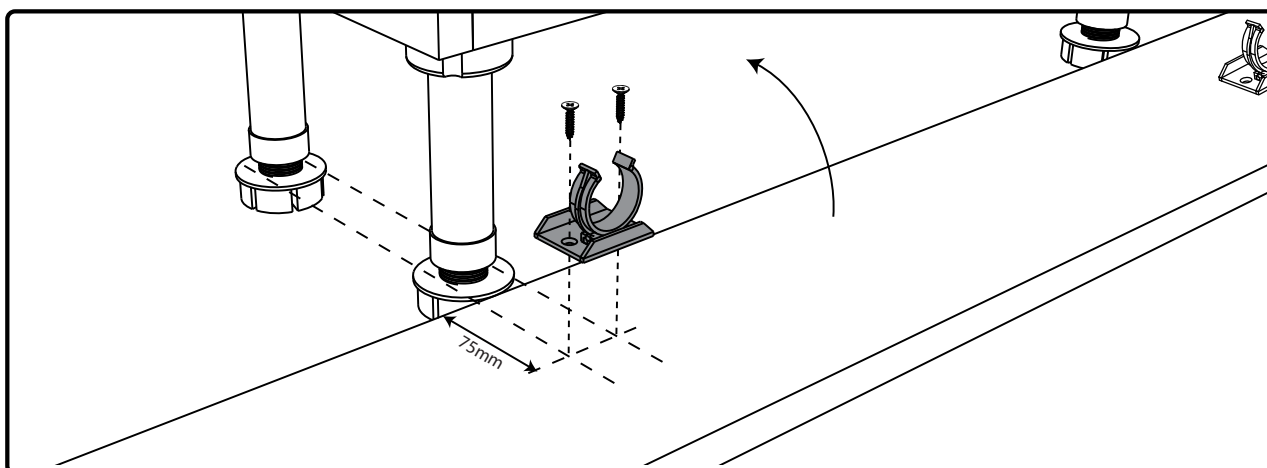
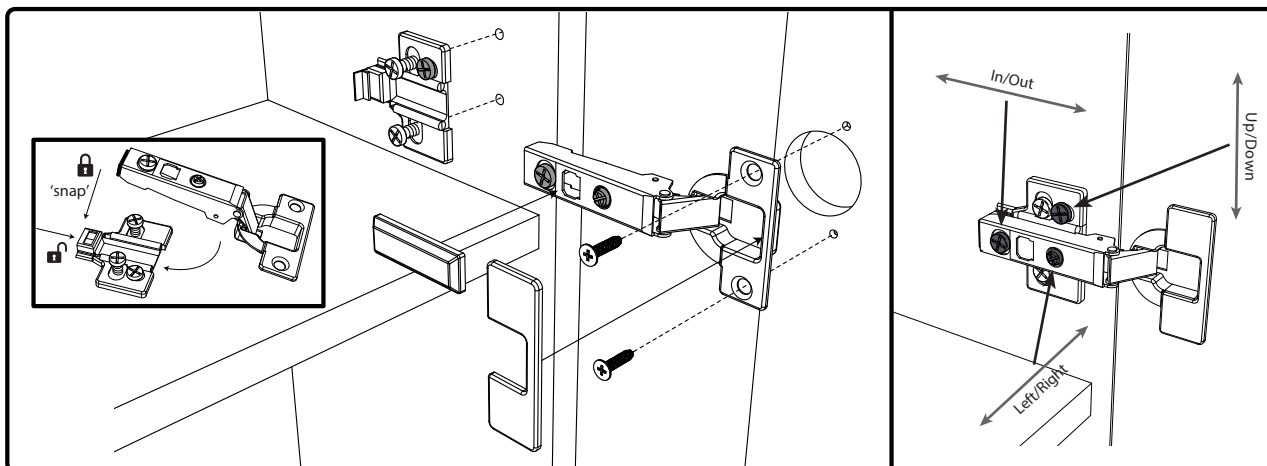
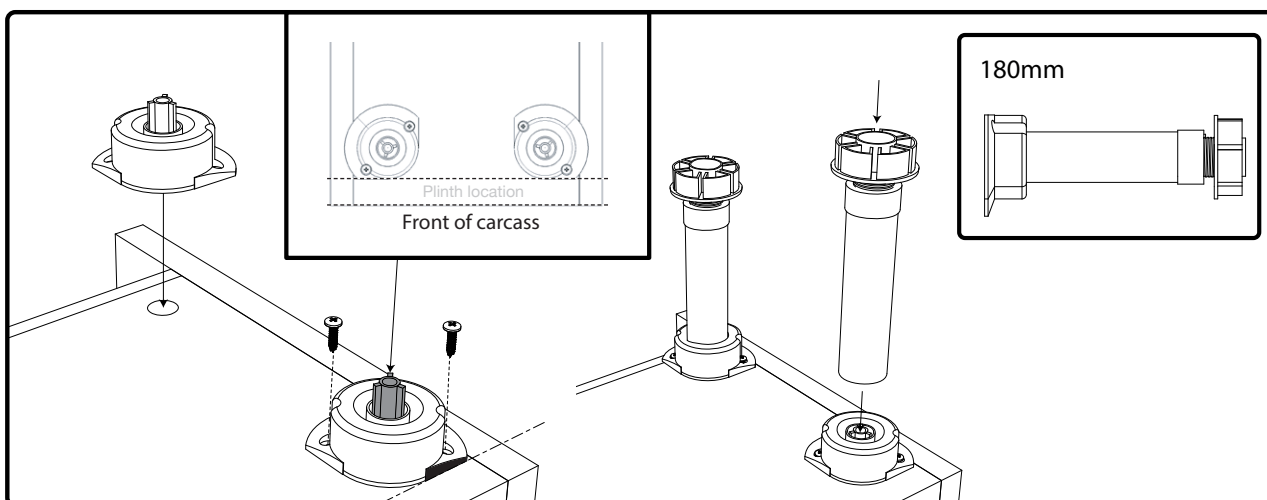
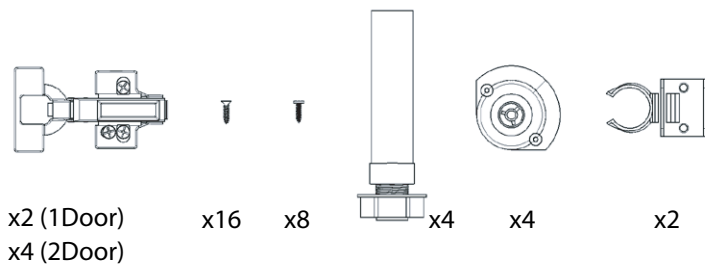

Wall Hanging Installation Manual

Hanging Brackets

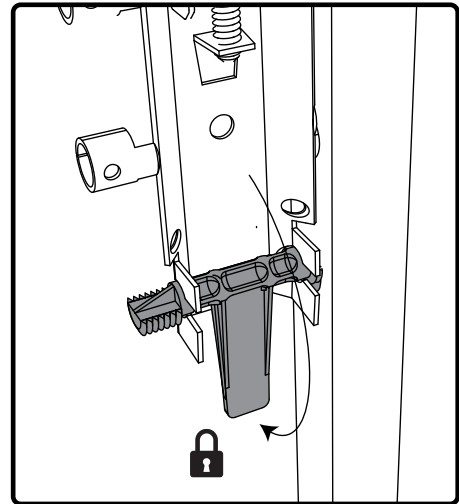
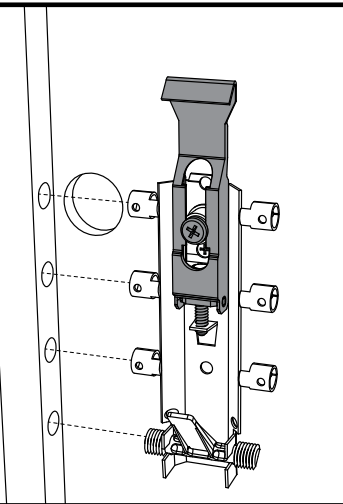
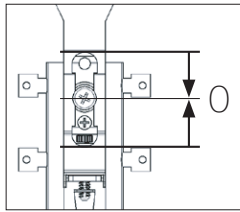

Hanging Plates

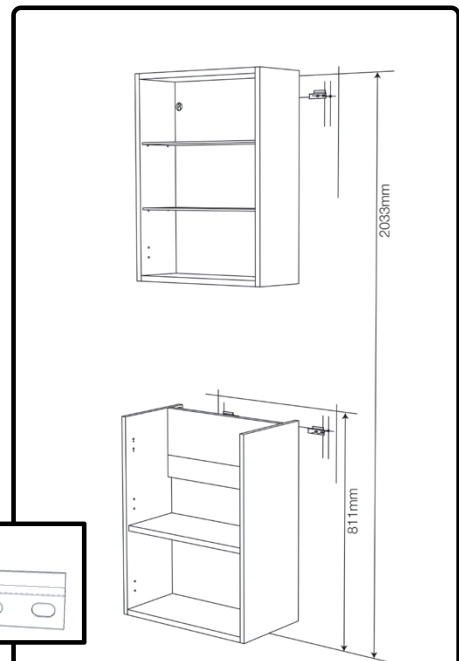
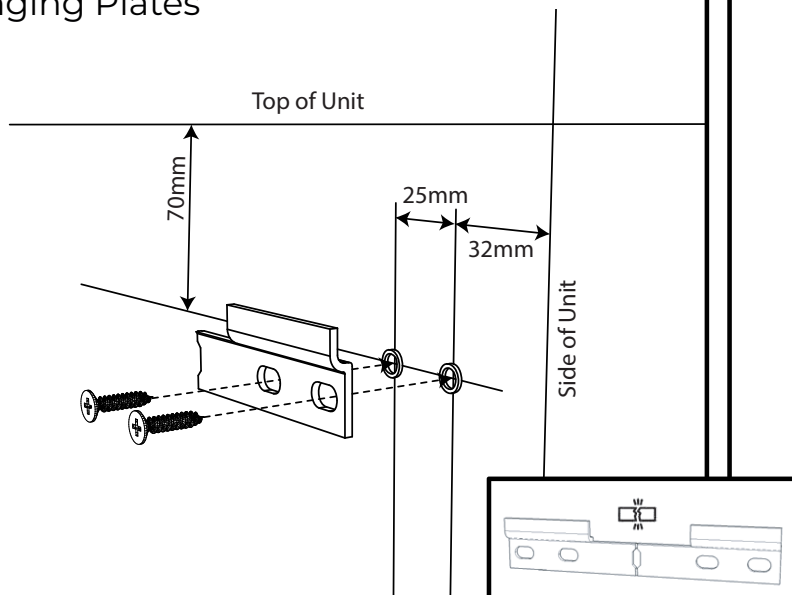

Levelling

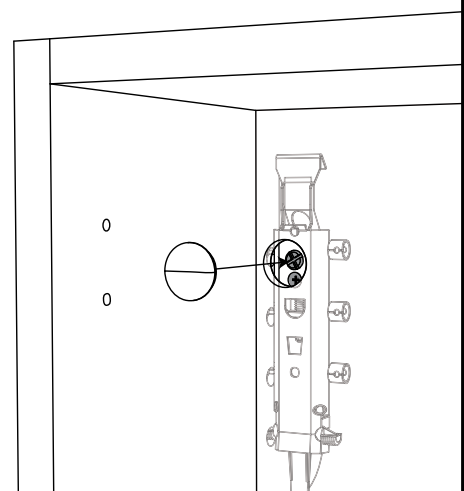
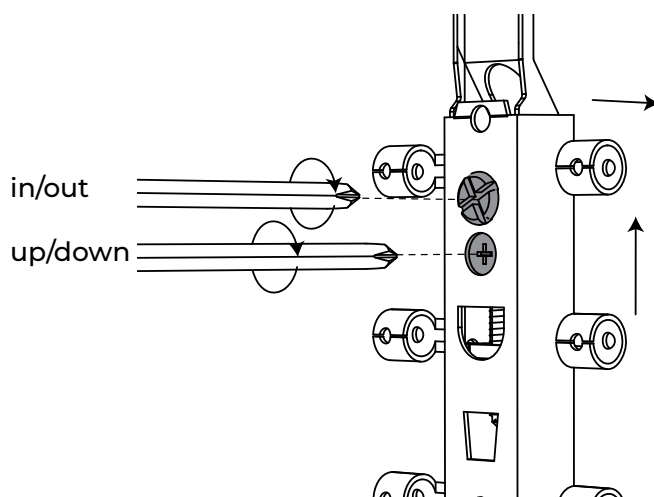

Bath Panels Installation Manual

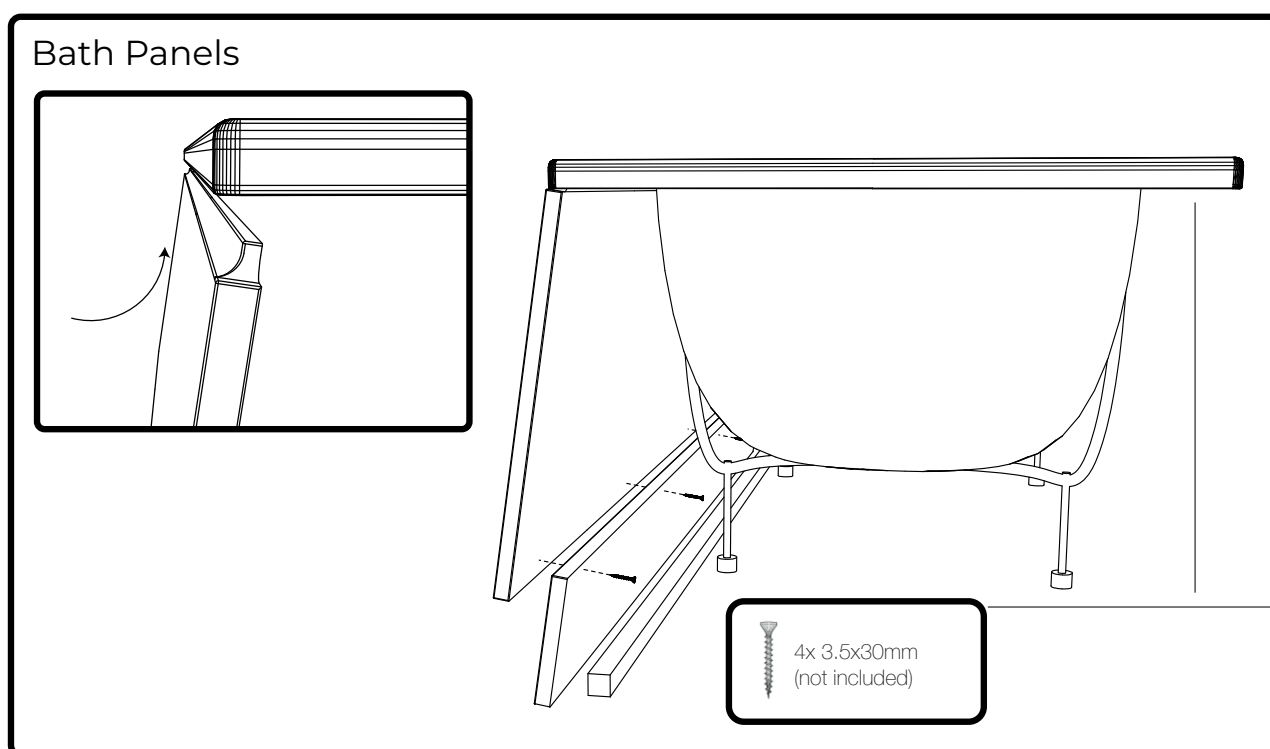

CARE INSTRUCTION

Please note that although these units have been designed to last for years, you will help maintain the products by following these guide lines.

Do not use solvent or abrasive cleaners to clean the units as they can cause permanent damage to the finish.

Occasional marks, can in most cases, be removed with a soft damp cloth. More persistent marks can be removed using a non silicone based furniture cleaner. Hot soapy water should be avoided as it can cause the foil to peel. Once the mark is removed, the area should be wiped over with a damp cloth to remove any excess and dried with a soft clean cloth.

Door hinges should be wiped with a damp soapy cloth and wiped dry with a soft cloth where necessary. The hinges are lubricated and should not be cleaned with a degreasing agent as this will affect the action of moving parts. Never lean on partially or fully opened doors in order to gain access to the units. The hinges are specified to adequately support the weight of the doors. It is advised that once the bathroom has been installed you should check every six months that all screws on the hinges are tight.

GENERAL CARE, SPILLAGE & SPLASHES

Do not allow any spillages or splashes, even water, lie on any surface. All spillages and splashes should be wiped dry, failure to do so may shorten the life expectancy of the product and invalidate any guarantees.